

2/16/2016

MADISON COUNTY, MISSISSIPPI
PERMIT APPLICATION FOR USE AND OCCUPANCY
FOR THE CONSTRUCTION OR ADJUSTMENT OF A UTILITY
WITHIN ROAD OR HIGHWAY RIGHT-OF-WAY

FACILITY ALONG STRIBLING COUNTY ROAD PROJECT NAME OR NUMBER

67J01464N COUNTY OF MADISON, BEGINNING IN SECTION 28, TOWNSHIP

8N, RANGE 2E, AND ENDING IN SECTION 21, TOWNSHIP

8N, RANGE 2E UTILITY NAME AT&T BY BRETT MARSHALL

TELEPHONE 601-859-3162 ADDRESS 370 CHURCH RD MADISON, MS 39110.

herein called APPLICANT, purposes to construct on Gluckstadt Rd a Utility Facility installed between station _____ and station _____ of Project Name/Number _____ and within road or highway right-of-way, and hereby makes application to the County for construction permit. Attached hereto are drawings or plans for the construction, which will not be changed or altered without approval of the Road Manager, or his representative.

Whereas, the Legislature of Mississippi has heretofore granted to the applicant the right to locate its facilities upon, across, under, over and along public highways and streets within the State of Mississippi; Applicant agrees to comply with applicable provisions of S.O.P. No. SAD II-2-8, Policy for the Accommodation of Utility Facilities within the Rights-of-Way of County Federal Aid and State Aid Highways (hereinafter referred to as the "Policy"), promulgated by the State Aid Engineer and dated January 1, 1983, and which is hereby made a part of this application Agreement, and agrees to perform the construction according to the applicable industry code and according to the plans and specifications for the Project.

The Applicant shall comply with all policies, procedures and construction practices as outlined in "A Policy for The Accommodation of Utility Facilities within the Right-of-Way of all Public County Roads", as adopted on May 1, 1992, by the Madison County Board of Supervisors.

The Applicant shall be responsible for the future maintenance and repair of the facilities. The Applicant shall make future adjustments in, or relocate, the facilities located within road or highway right-of-way when required for road or highway widening or other road or highway construction at no cost to the county. The Applicant Utility shall relocate said utilities within sixty (60) days of notification by County by registered mail, return receipt requested, unless otherwise designated by the County's Road Manager. Further, any maintenance, repair, or construction shall be done in such a manner as to occasion no unreasonable interference with the

normal flow and safety to traffic and at the expense of the utility company. When reasonable care has been taken to locate said utility facilities within the right-of-way, the applicant understands that any damages caused by routine maintenance and construction by county forces shall be borne by the applicant Utility.

A general description of the size, type, nature, and extent of the Utility work to be done is as follows: BORE 90' OF FIBER CABLE ACROSS INDUSTRIAL DR. BORE 128' OF FIBER CABLE NORTH ALONG INDUSTRIAL DR. BORE 1476' OF FIBER CABLE ALONG GLUCKSTADT RD. BORE 47' OF FIBER CABLE ACROSS GLUCKSTADT RD. BORE FIBER CABLE TO BE PLACED IN THE BACK 5' OF ROW. ANY CABLE MARKERS TO BE PLACED SHOULD BE AT REAR OF ROW SO NOT TO INTERFERE WITH COUNTY MAINTENANCE.

The applicant understands and agrees that, except as herein granted, no right, title, claim, or easement to said road right-of-way is granted by the issuance of this permit and if this Utility Facility as listed in the general provisions of the Policy, it will be adjusted to comply with same without cost to the County, unless the variance from the Policy has been approved by the granting of the Permit pursuant to this Application.

The Applicant further understands that the Utility's engineering, plant, or other personnel will be responsible for the staking and construction supervision of the work set out above and as shown on the attached plans.

The applicant further agrees to indemnify and hold county harmless for any and all claims, accidents, damages, liabilities and expenses occasioned wholly, or in part, by any act or omission of applicant, its agents or employees. In case County shall, without fault on its own part, be made a party to any litigation commenced by or against applicant, then applicant shall protect and hold County harmless, and shall pay all costs, expenses and reasonable attorney's fees incurred or paid by County in connection with said litigation.

Madison County agrees to the following stipulations:

- (1) To cooperate with the Utility Company in every way to avoid conflicts in the location, construction, and maintenance of the County Highway and Utility Facility.
- (2) To pursue any and all legal means to see the Policy Standards, except to the extent of any variance shown on the plans filed herewith and approved, are complied with in the facility installation.
- (3) If the County Road Manager or his authorized representative approved the drawing, sketches, and plans submitted by the Applicant, he shall so indicate by signing and dating the Permit Approval at the end of this application, and the Applicant may proceed with the installation; if the drawings, sketches, and plans are not approved, he shall promptly notify the Applicant, and advise it of the reason or reasons. He will also act as the duly appointed representative of the Board of Supervisors and will give his approval to the completed work as being in compliance with the location and standards shown in the Policy and in the Agreement for the installations.

(4) That all joint highway construction and utility adjustment or relocation operations will comply with the requirements of Section S-105.06 and Section S-107-18, Mississippi Standard Specifications for State Aid Road and Bridge Construction, 1989 edition (or current edition).

(5) Should any term of provision of this Applicant Agreement conflict with the law of the State of Mississippi, the Mississippi Constitution, or the United States Constitution, or impair or deny to the Applicant or the County any right protected thereby, it shall be deemed amended to conform to said law or Constitution.

WITNESS the signature of the Applicant this the 16th day of November, 2016.

By: 
(Applicant Signature)

Title: Mgr OPS Plng & Design SE/CA

AGREED TO AND APPROVED BY:

_____ Date: _____
Mr. Trey Baxter
Madison County Board President

ENTERED INTO THE MINUTES OF THE BOARD OF SUPERVISORS OF MADISON COUNTY,
MISSISSIPPI OF THIS _____ DAY OF _____, 20_____.



County Engineer

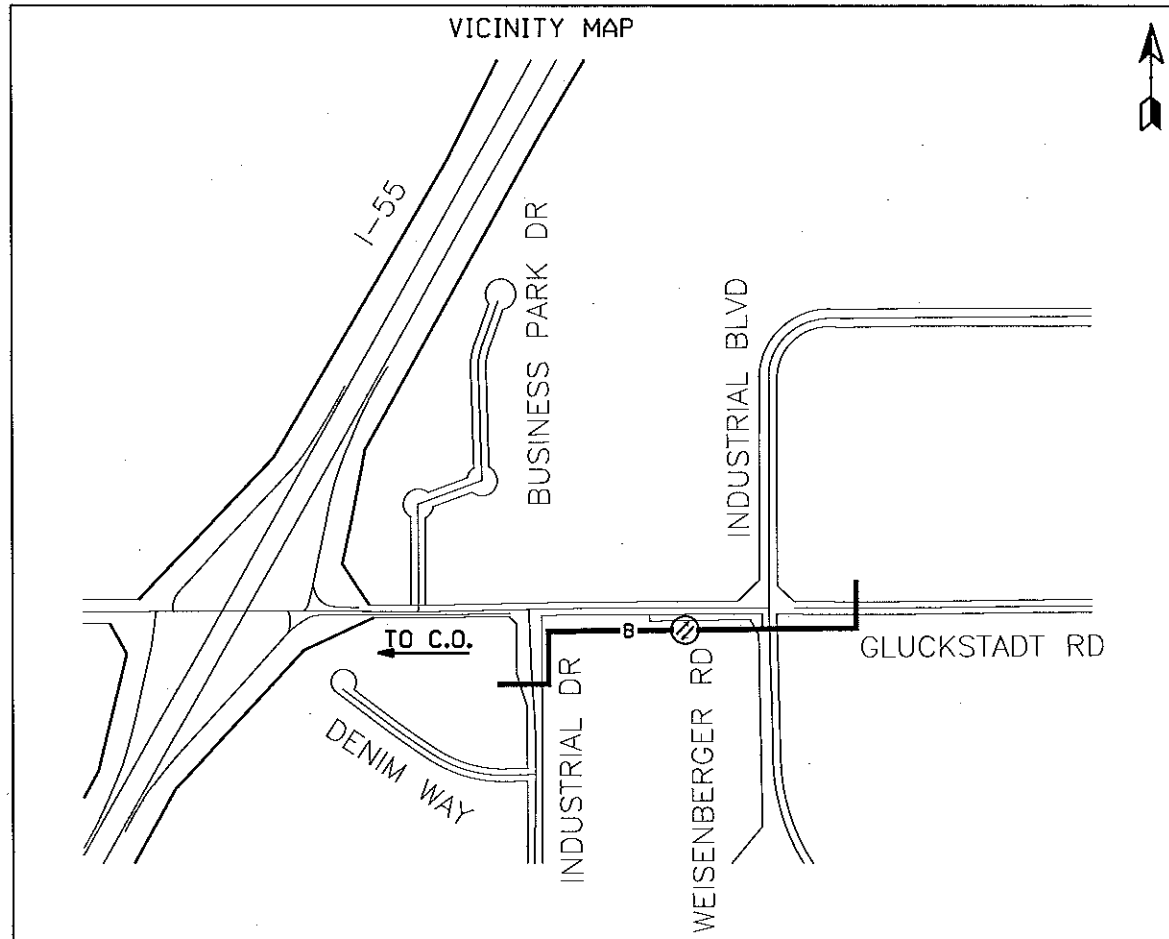

SYMBOL LEGEND		
Proposed	Existing	Description
		AERIAL CABLE
		BURIED CABLE
		BUR JOINT-TRENCH
		BST POLE
		POWER POLE
		ANCHOR & GUY
		PUSH BRACE
		ENCLOSURE
		ENCLOSURE
		MANHOLE
		PIPE/CONDUIT
		CABLE MARKER
		AERIAL SVC WIRE
		BURIED SVC WIRE
		JOINT-TRENCH SVC
	N/A	BORE
	N/A	CUT PAVEMENT
	N/A	SPLICING PIT
	N/A	TRENCH LEN&DEPTH

ATTSE	
PROPOSED TELEPHONE FACILITIES ON RIGHT OF WAY OF MADISON COUNTY	
GLUCKSTADT RD	
Exchange:	601856
Designer:	Marshall, Brett
Phone:	601-859-3162
Authorization:	67J01464N
Dwg. <u> 1 </u> of <u> 5 </u>	

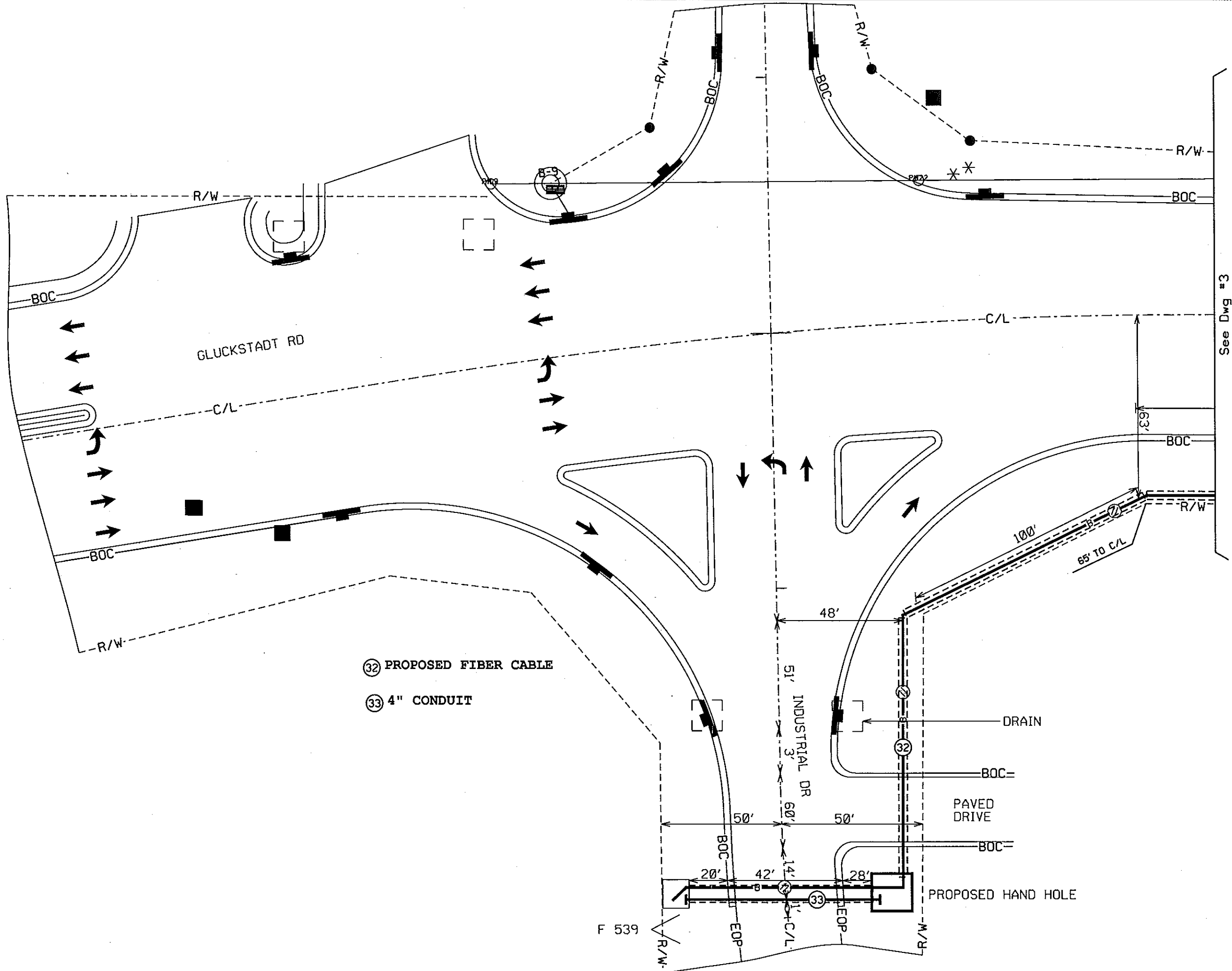

See Dwg #3

- ③② PROPOSED FIBER CABLE
- ③③ 4" CONDUIT

ATTSE	
PROPOSED TELEPHONE FACILITIES ON RIGHT OF WAY OF MADISON COUNTY	
GLUCKSTADT RD	
Exchange:	601856
Designer:	Marshall, Brett
Phone:	601-859-3162
Authorization:	67J01464N
Dwg.	2 of 5

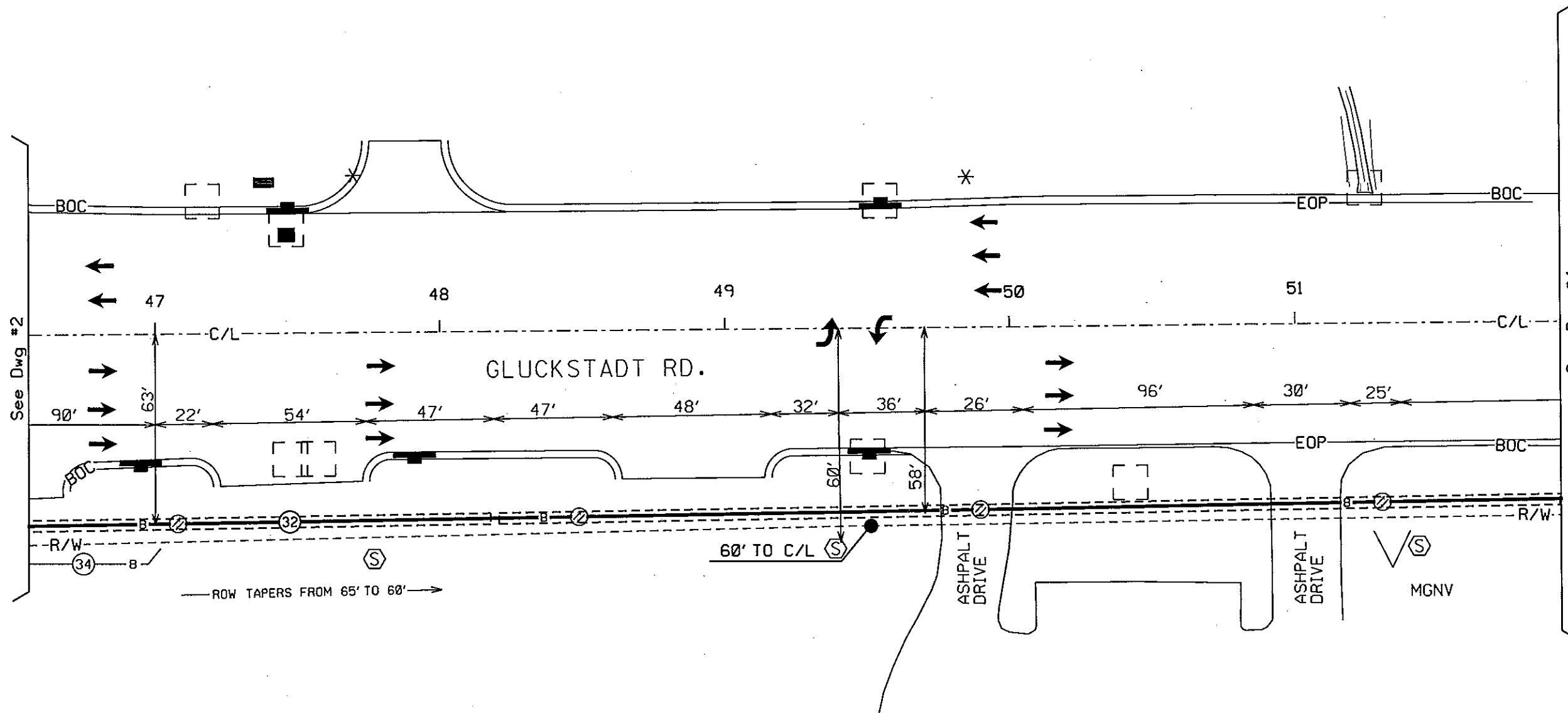

ATTSE	
PROPOSED TELEPHONE FACILITIES ON RIGHT OF WAY OF MADISON COUNTY	
GLUCKSTADT RD	
Exchange:	601856
Designer:	Marshall, Brett
Phone:	601-859-3162
Authorization:	67J01464N
Dwg.	3 of 5

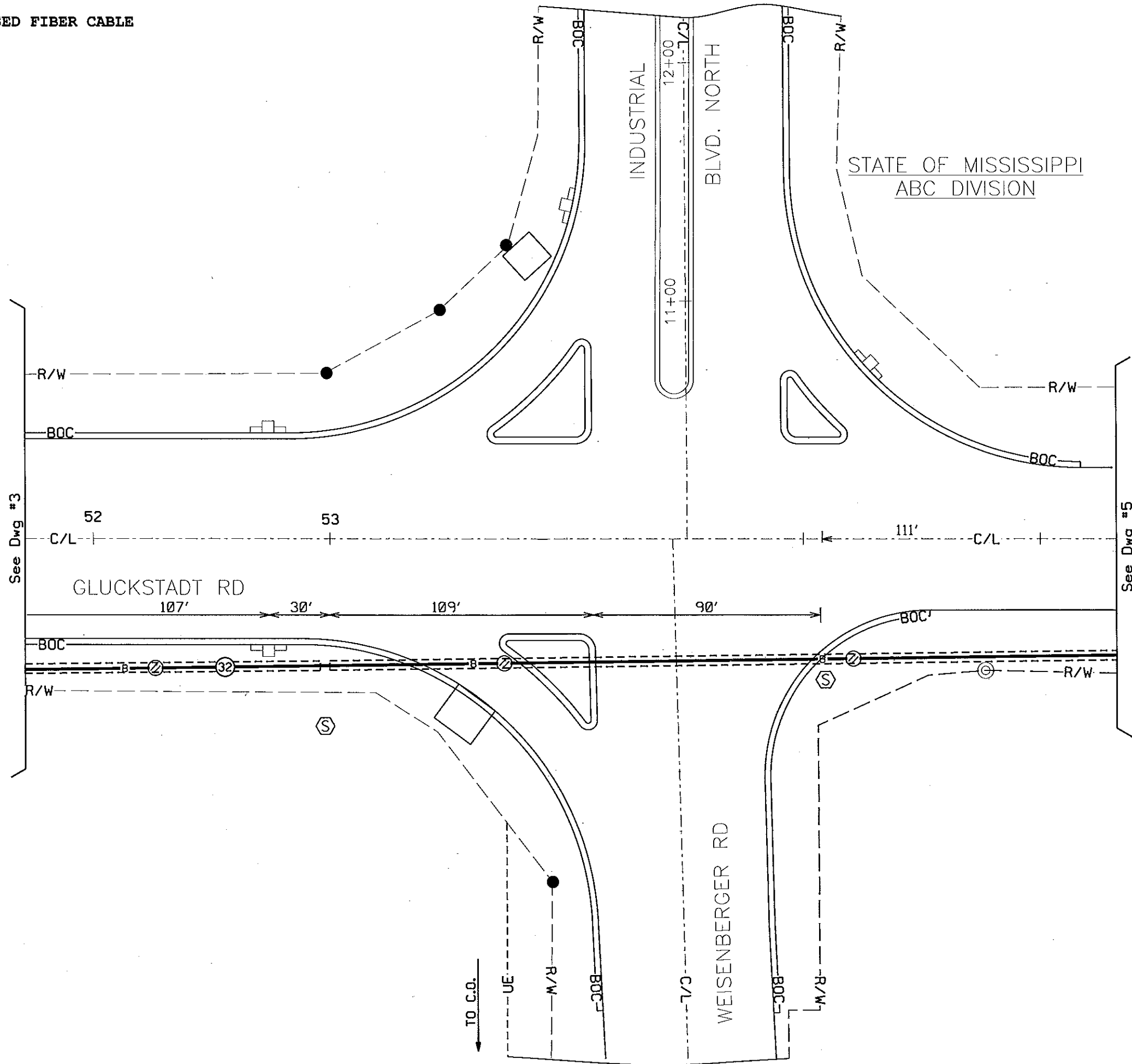
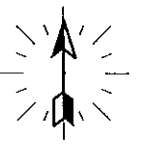

See Dwg #3

See Dwg #5

ATTSE	
PROPOSED TELEPHONE FACILITIES ON RIGHT OF WAY OF MADISON COUNTY	
GLUCKSTADT RD	
Exchange:	601856
Designer:	Marshall, Brett
Phone:	601-859-3162
Authorization:	67J01464N
Dwg. <u>4</u> of <u>5</u>	

32 PROPOSED FIBER CABLE

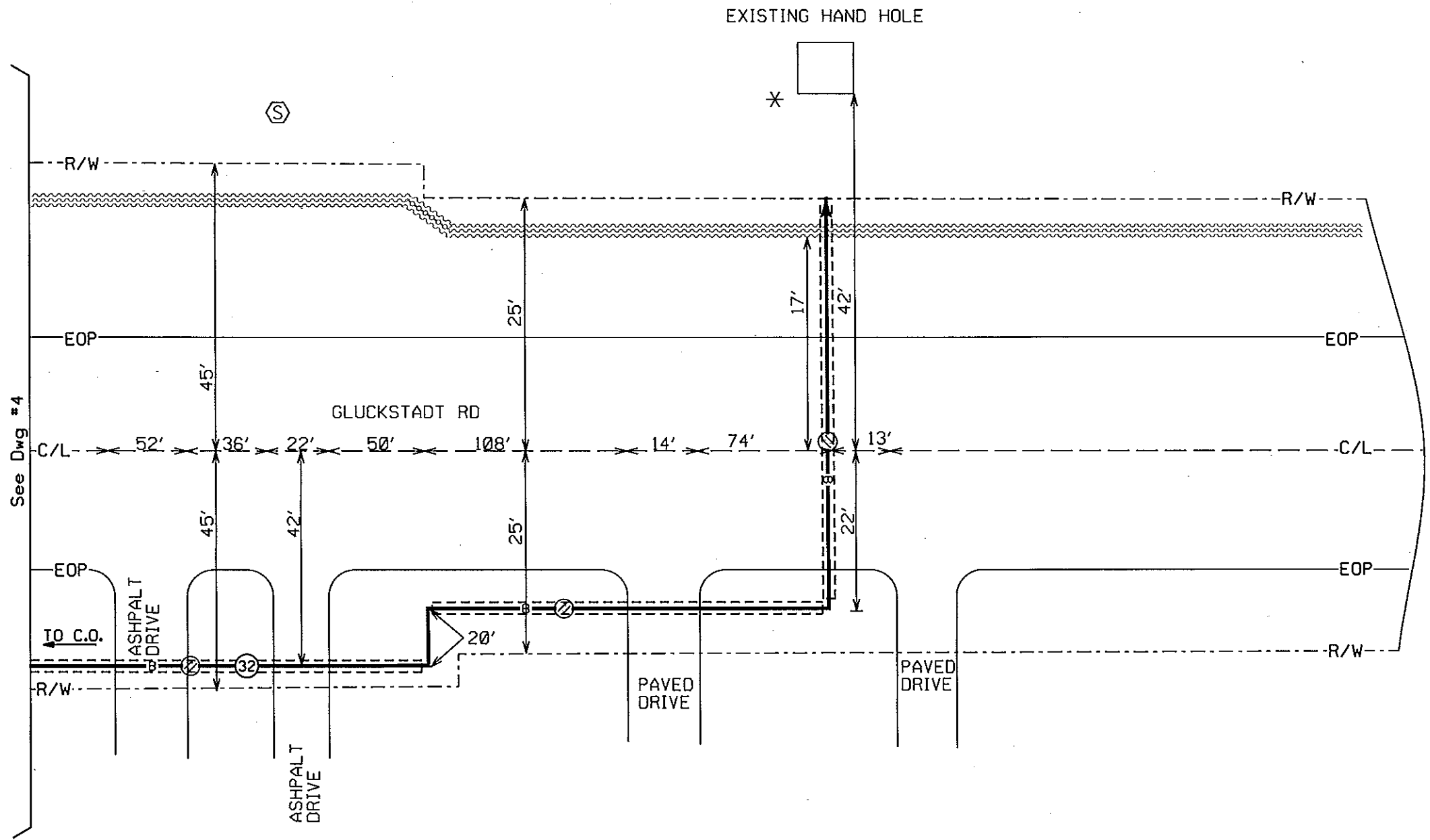
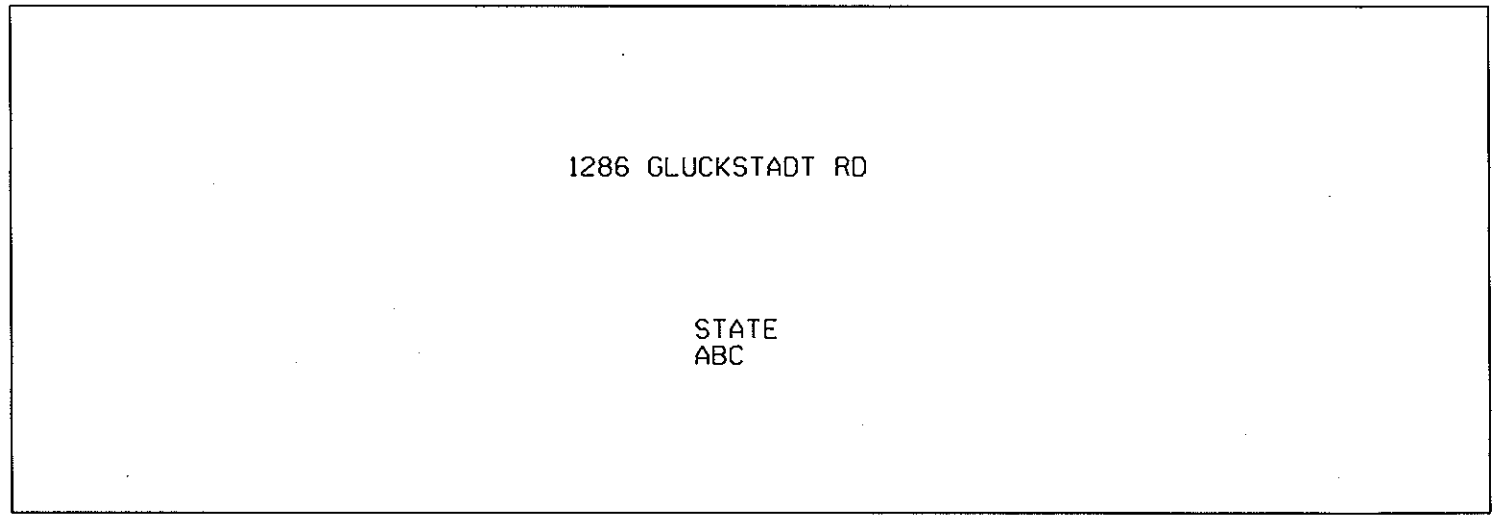

ATTSE	
PROPOSED TELEPHONE FACILITIES ON RIGHT OF WAY OF MADISON COUNTY	
GLUCKSTADT RD	
Exchange:	601856
Designer:	Marshall, Brett
Phone:	601-859-3162
Authorization:	67J01464N
Dwg.	5 of 5

2/26/2016

MADISON COUNTY, MISSISSIPPI
PERMIT APPLICATION FOR USE AND OCCUPANCY
FOR THE CONSTRUCTION OR ADJUSTMENT OF A UTILITY
WITHIN ROAD OR HIGHWAY RIGHT-OF-WAY

FACILITY ALONG STRIBLING COUNTY ROAD PROJECT NAME OR NUMBER

67J01456N COUNTY OF MADISON, BEGINNING IN SECTION 21, TOWNSHIP

8N, RANGE 2E, AND ENDING IN SECTION 21, TOWNSHIP

8N, RANGE 2E UTILITY NAME AT&T BY BRETT MARSHALL

TELEPHONE 601-859-3162 ADDRESS 370 CHURCH RD MADISON, MS 39110.

herein called APPLICANT, purposes to construct on Calhoun Pkwy a Utility Facility installed between station _____ and station _____ of Project Name/Number _____ and within road or highway right-of-way, and hereby makes application to the County for construction permit. Attached hereto are drawings or plans for the construction, which will not be changed or altered without approval of the Road Manager, or his representative.

Whereas, the Legislature of Mississippi has heretofore granted to the applicant the right to locate its facilities upon, across, under, over and along public highways and streets within the State of Mississippi; Applicant agrees to comply with applicable provisions of S.O.P. No. SAD II-2-8, Policy for the Accommodation of Utility Facilities within the Rights-of-Way of County Federal Aid and State Aid Highways (hereinafter referred to as the "Policy"), promulgated by the State Aid Engineer and dated January 1, 1983, and which is hereby made a part of this application Agreement, and agrees to perform the construction according to the applicable industry code and according to the plans and specifications for the Project.

The Applicant shall comply with all policies, procedures and construction practices as outlined in "A Policy for The Accommodation of Utility Facilities within the Right-of-Way of all Public County Roads", as adopted on May 1, 1992, by the Madison County Board of Supervisors.

The Applicant shall be responsible for the future maintenance and repair of the facilities. The Applicant shall make future adjustments in, or relocate, the facilities located within road or highway right-of-way when required for road or highway widening or other road or highway construction at no cost to the county. The Applicant Utility shall relocate said utilities within sixty (60) days of notification by County by registered mail, return receipt requested, unless otherwise designated by the County's Road Manager. Further, any maintenance, repair, or construction shall be done in such a manner as to occasion no unreasonable interference with the

normal flow and safety to traffic and at the expense of the utility company. When reasonable care has been taken to locate said utility facilities within the right-of-way, the applicant understands that any damages caused by routine maintenance and construction by county forces shall be borne by the applicant Utility.

A general description of the size, type, nature, and extent of the Utility work to be done is as follows: BORE 1738' OF COPPER AND FIBER CABLE ALONG CALHOUN PKWY.
BORE 95' OF FIBER CABLE ACROSS CALHOUN PKWY. ALL CABLE TO BE PLACED
IN THE BACK 5' OF ROW. ANY CABLE MARKERS TO BE PLACED SHOULD BE AT
REAR OF ROW SO NOT TO INTERFERE WITH COUNTY MAINTENANCE.

The applicant understands and agrees that, except as herein granted, no right, title, claim, or easement to said road right-of-way is granted by the issuance of this permit and if this Utility Facility as listed in the general provisions of the Policy, it will be adjusted to comply with same without cost to the County, unless the variance from the Policy has been approved by the granting of the Permit pursuant to this Application.

The Applicant further understands that the Utility's engineering, plant, or other personnel will be responsible for the staking and construction supervision of the work set out above and as shown on the attached plans.

The applicant further agrees to indemnify and hold county harmless for any and all claims, accidents, damages, liabilities and expenses occasioned wholly, or in part, by any act or omission of applicant, its agents or employees. In case County shall, without fault on its own part, be made a party to any litigation commenced by or against applicant, then applicant shall protect and hold County harmless, and shall pay all costs, expenses and reasonable attorney's fees incurred or paid by County in connection with said litigation.

Madison County agrees to the following stipulations:

- (1) To cooperate with the Utility Company in every way to avoid conflicts in the location, construction, and maintenance of the County Highway and Utility Facility.
- (2) To pursue any and all legal means to see the Policy Standards, except to the extent of any variance shown on the plans filed herewith and approved, are complied with in the facility installation.
- (3) If the County Road Manager or his authorized representative approved the drawing, sketches, and plans submitted by the Applicant, he shall so indicate by signing and dating the Permit Approval at the end of this application, and the Applicant may proceed with the installation; if the drawings, sketches, and plans are not approved, he shall promptly notify the Applicant, and advise it of the reason or reasons. He will also act as the duly appointed representative of the Board of Supervisors and will give his approval to the completed work as being in compliance with the location and standards shown in the Policy and in the Agreement for the installations.

(4) That all joint highway construction and utility adjustment or relocation operations will comply with the requirements of Section S-105.06 and Section S-107-18, Mississippi Standard Specifications for State Aid Road and Bridge Construction, 1989 edition (or current edition).

(5) Should any term of provision of this Applicant Agreement conflict with the law of the State of Mississippi, the Mississippi Constitution, or the United States Constitution, or impair or deny to the Applicant or the County any right protected thereby, it shall be deemed amended to conform to said law or Constitution.

WITNESS the signature of the Applicant this the 26th day of February, 2016.

By: 
(Applicant Signature)

Title: Mgr OPS Png & Design SE/CA

AGREED TO AND APPROVED BY:

Mr. Trey Baxter
Madison County Board President

Date: _____

ENTERED INTO THE MINUTES OF THE BOARD OF SUPERVISORS OF MADISON COUNTY,

MISSISSIPPI OF THIS _____ DAY OF _____, 20_____.

County Engineer



VICINITY MAP
MADISON COUNTY
CANTON, MS

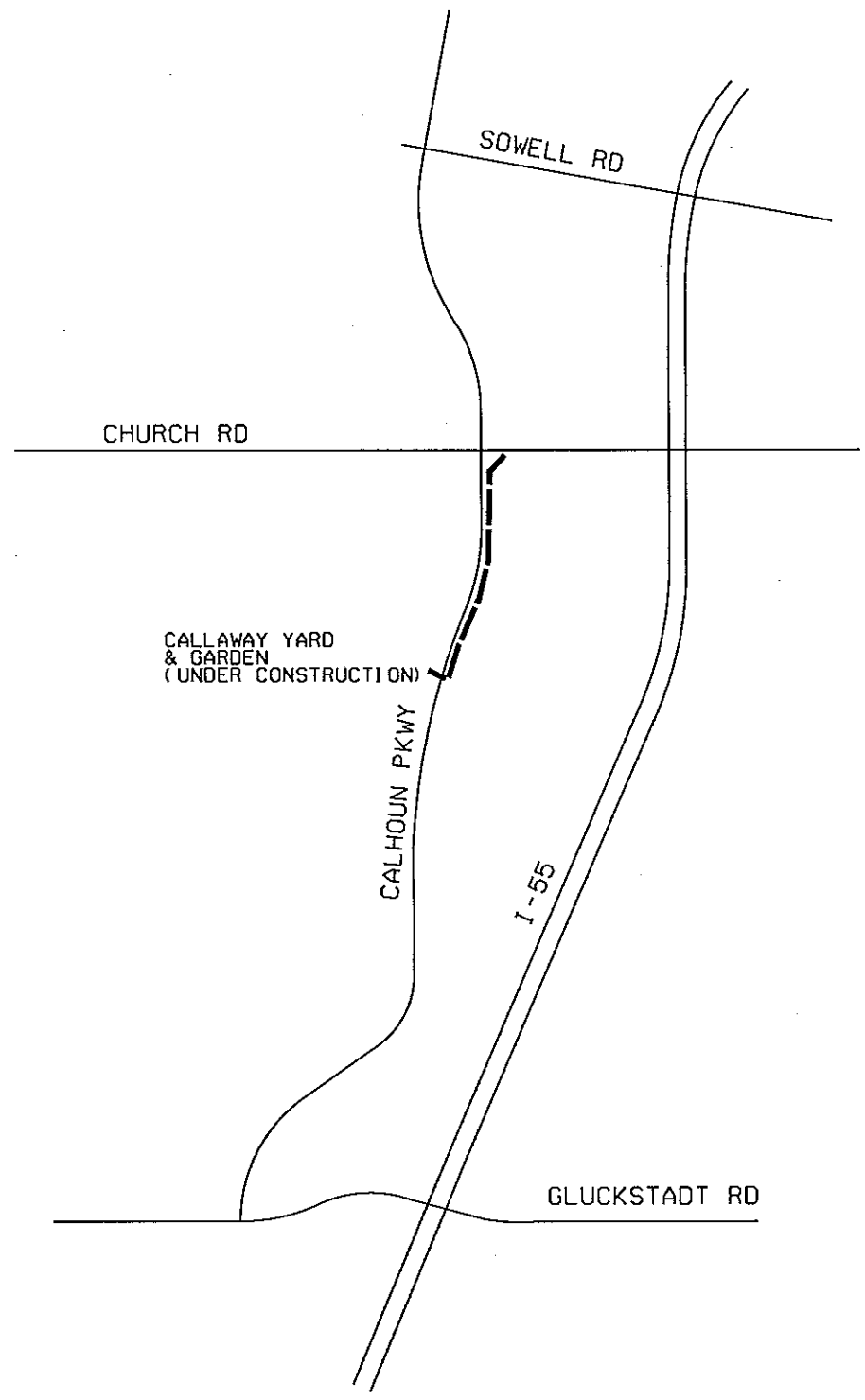

SYMBOL LEGEND		
Proposed	Existing	Description
		AERIAL CABLE
		BURIED CABLE
		BUR JOINT-TRENCH
		BST POLE
		POWER POLE
		ANCHOR & GUY
		PUSH BRACE
		ENCLOSURE
		ENCLOSURE
		MANHOLE
		PIPE/CONDUIT
		CABLE MARKER
		AERIAL SVC WIRE
		BURIED SVC WIRE
		JOINT-TRENCH SVC
	N/A	BORE
	N/A	CUT PAVEMENT
	N/A	SPLICING PIT
	N/A	TRENCH LEN@DEPTH

ATTSE	
PROPOSED TELEPHONE FACILITIES ON RIGHT OF WAY OF	
Church Rd & Calhoun	
Exchange:	601859 Canton
Designer:	Marshall, Brett
Phone:	601-859-3162
Authorization:	67J01456N
Dwg.	1 of 6

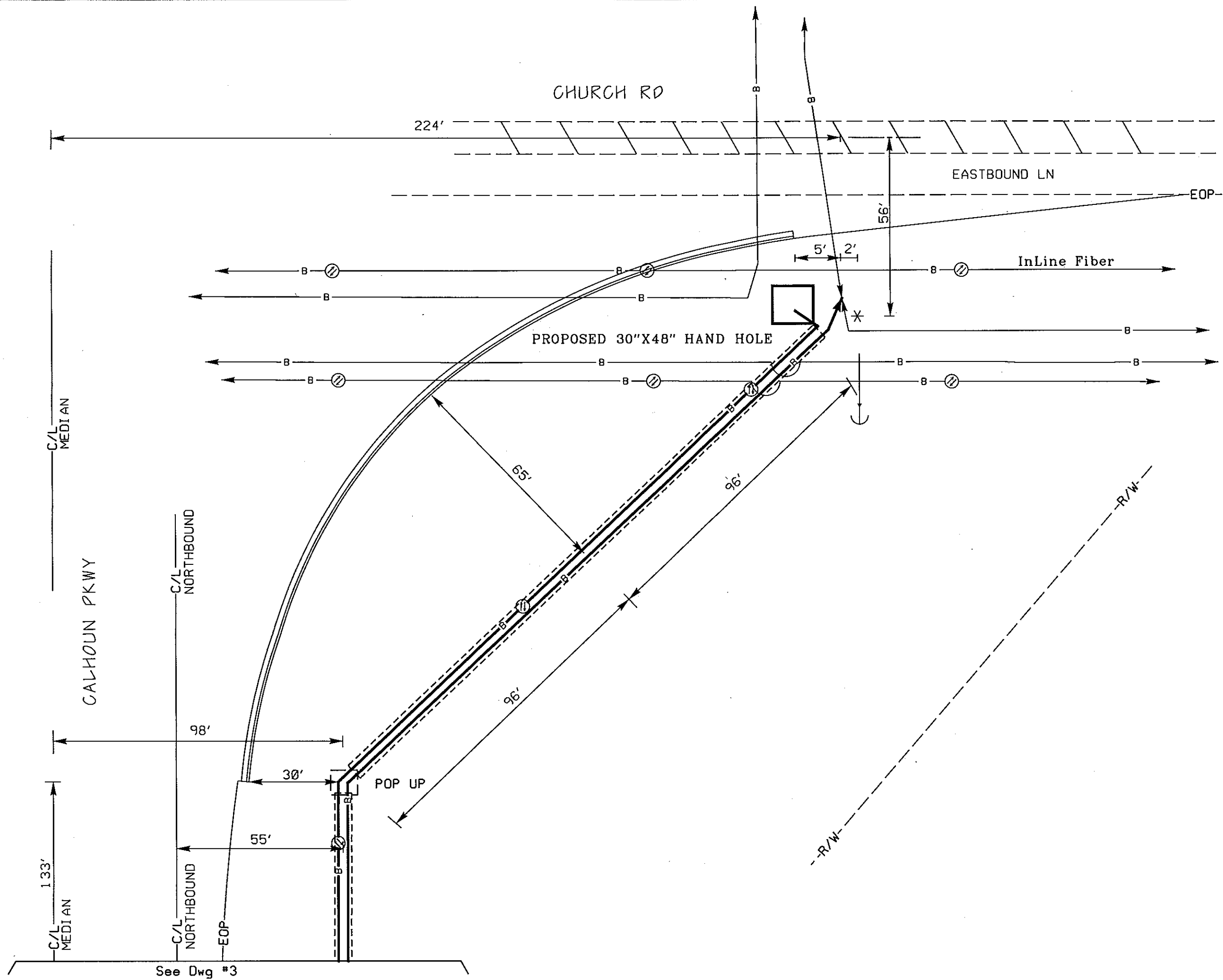

See Dwg #3

ATTSE	
PROPOSED TELEPHONE FACILITIES ON RIGHT OF WAY OF	
Church Rd & Calhoun	
Exchange:	601859 Canton
Designer:	Marshall, Brett
Phone:	601-859-3162
Authorization:	67J01456N
Dwg.	2 of 6

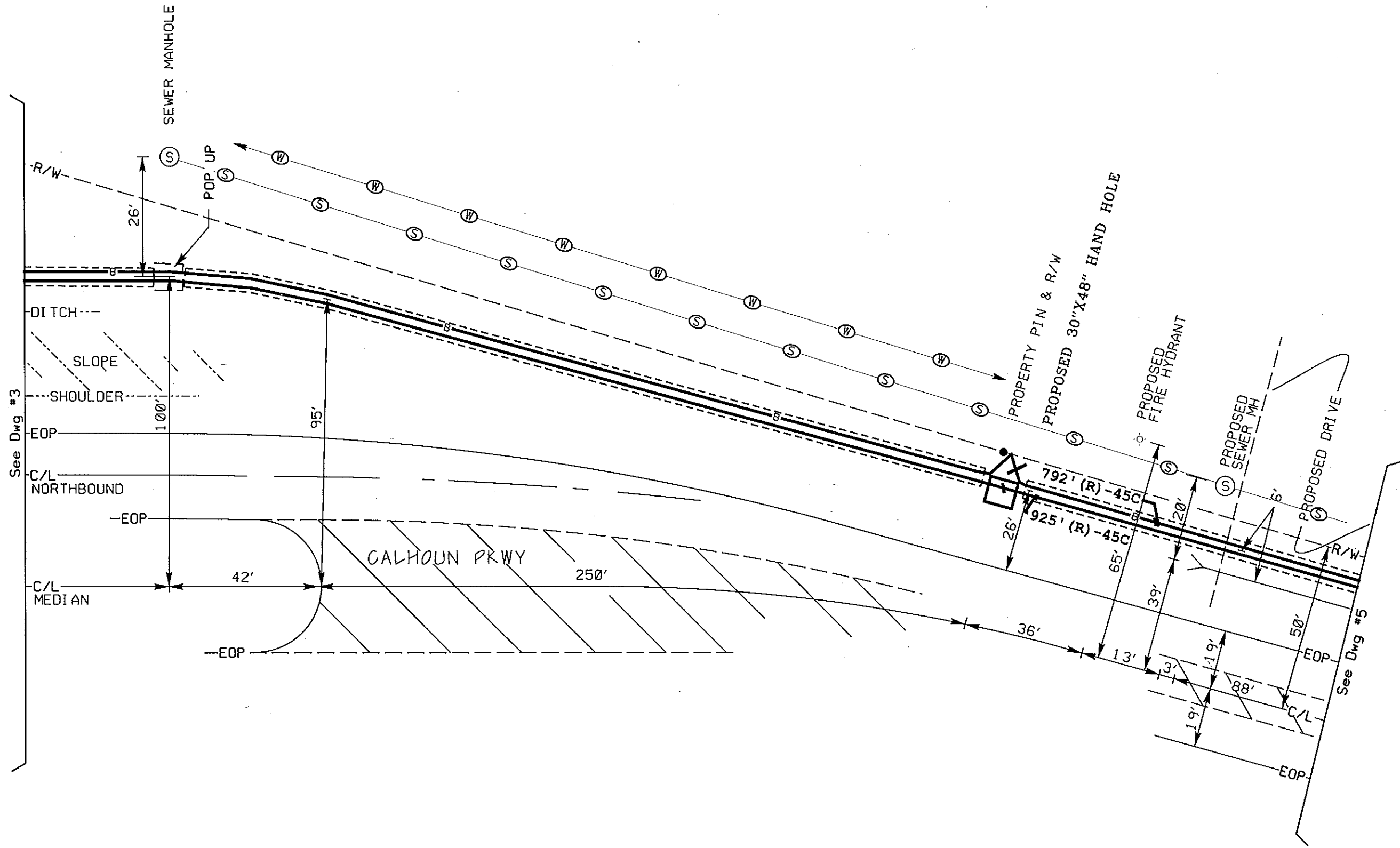
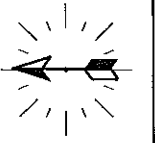

ATTSE	
PROPOSED TELEPHONE FACILITIES ON RIGHT OF WAY OF	
Church Rd & Calhoun	
Exchange:	601859 Canton
Designer:	Marshall, Brett
Phone:	601-859-3162
Authorization:	67J01456N
Dwg.	4 of 6

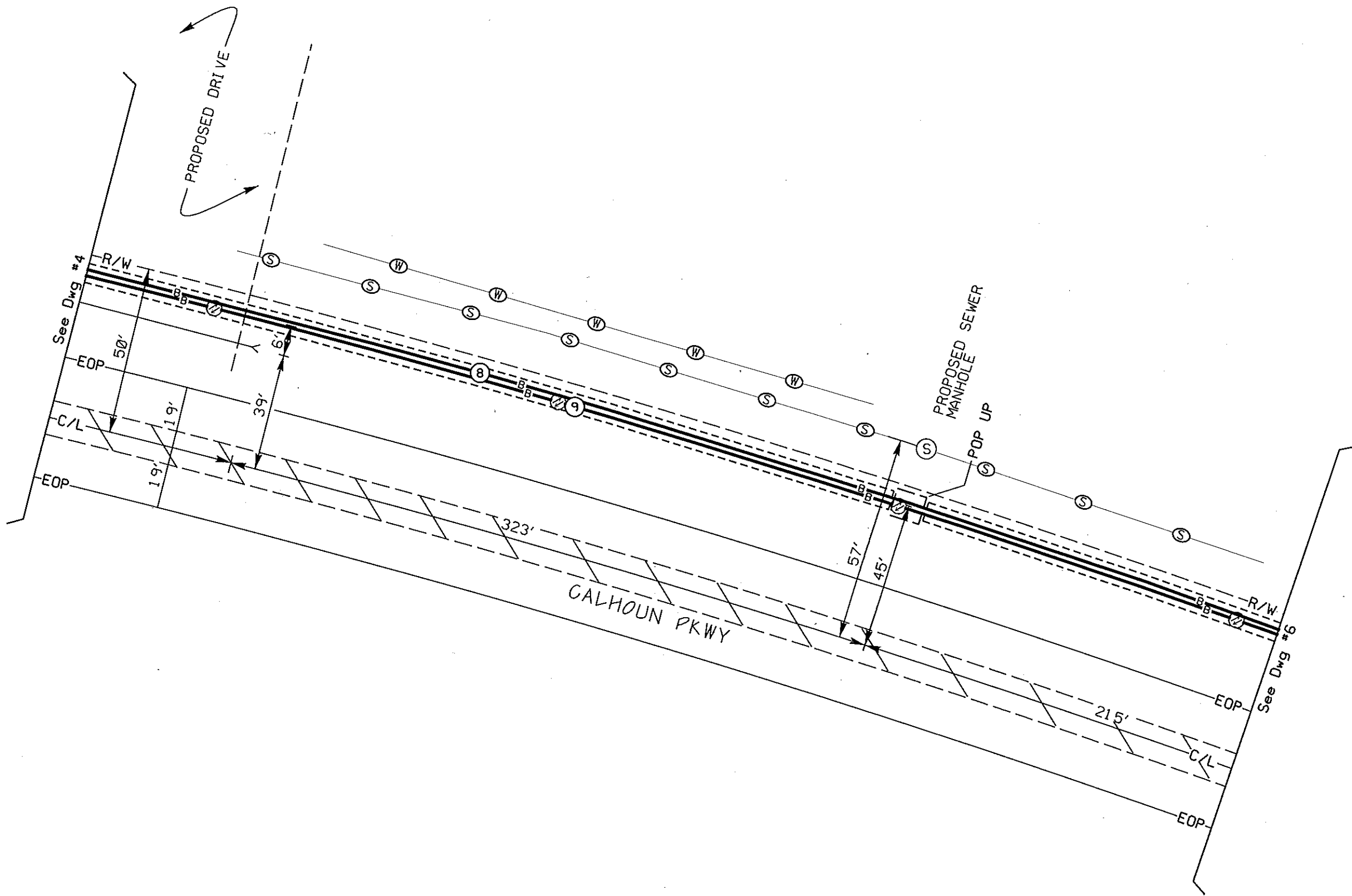
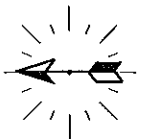

ATTSE	
PROPOSED TELEPHONE FACILITIES ON RIGHT OF WAY OF	
Church Rd & Calhoun	
Exchange:	601859 Canton
Designer:	Marshall, Brett
Phone:	601-859-3162
Authorization:	67J01456N
Dwg.	5 of 6

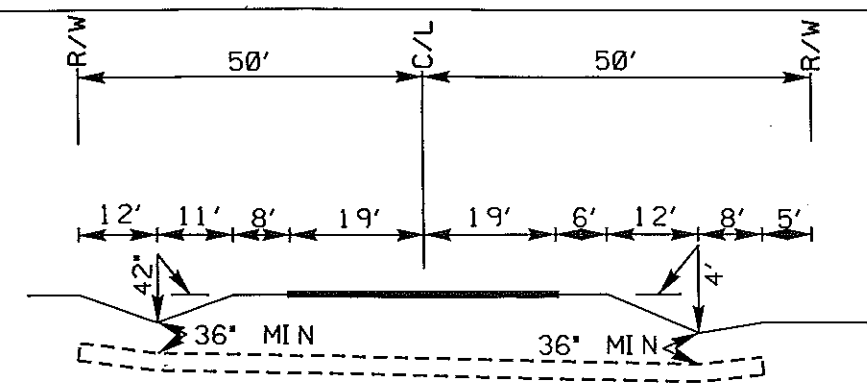
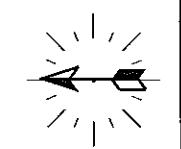

PROFILE
FACING NORTH

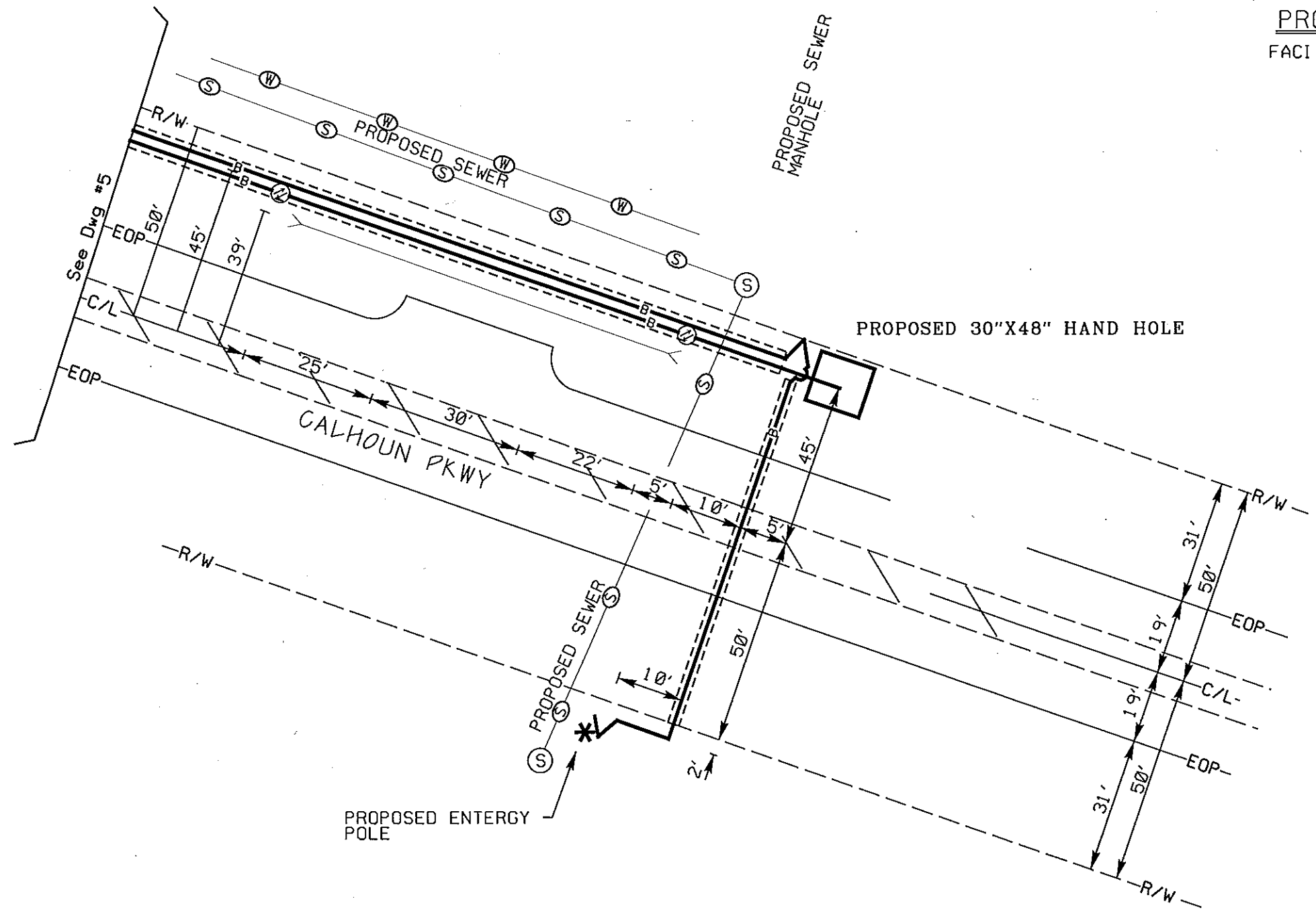

PROPOSED 30"X48" HAND HOLE

PROPOSED ENERGY POLE

Callaways Yard & Garden
(under construction)

ATTSE	
PROPOSED TELEPHONE FACILITIES ON RIGHT OF WAY OF	
Church Rd & Calhoun	
Exchange:	601859 Canton
Designer:	Marshall, Brett
Phone:	601-859-3162
Authorization:	67J01456N
Dwg.	6 of 6

2/12/2016

MADISON COUNTY, MISSISSIPPI
PERMIT APPLICATION FOR USE AND OCCUPANCY
FOR THE CONSTRUCTION OR ADJUSTMENT OF A UTILITY
WITHIN ROAD OR HIGHWAY RIGHT-OF-WAY

FACILITY ALONG STRIBLING COUNTY ROAD PROJECT NAME OR NUMBER

67J90549N COUNTY OF MADISON, BEGINNING IN SECTION 21, TOWNSHIP

8N, RANGE 2E, AND ENDING IN SECTION 21, TOWNSHIP

8N, RANGE 2E UTILITY NAME AT&T BY BRETT MARSHALL

TELEPHONE 601-859-3162 ADDRESS 370 CHURCH RD MADISON, MS 39110.

herein called APPLICANT, purposes to construct on Industrial Blvd and Industrial Dr N a Utility Facility installed between station _____ and station _____ of Project Name/Number _____ and within road or highway right-of-way, and hereby makes application to the County for construction permit. Attached hereto are drawings or plans for the construction, which will not be changed or altered without approval of the Road Manager, or his representative.

Whereas, the Legislature of Mississippi has heretofore granted to the applicant the right to locate its facilities upon, across, under, over and along public highways and streets within the State of Mississippi; Applicant agrees to comply with applicable provisions of S.O.P. No. SAD II-2-8, Policy for the Accommodation of Utility Facilities within the Rights-of-Way of County Federal Aid and State Aid Highways (hereinafter referred to as the "Policy"), promulgated by the State Aid Engineer and dated January 1, 1983, and which is hereby made a part of this application Agreement, and agrees to perform the construction according to the applicable industry code and according to the plans and specifications for the Project.

The Applicant shall comply with all policies, procedures and construction practices as outlined in "A Policy for The Accommodation of Utility Facilities within the Right-of-Way of all Public County Roads", as adopted on May 1, 1992, by the Madison County Board of Supervisors.

The Applicant shall be responsible for the future maintenance and repair of the facilities. The Applicant shall make future adjustments in, or relocate, the facilities located within road or highway right-of-way when required for road or highway widening or other road or highway construction at no cost to the county. The Applicant Utility shall relocate said utilities within sixty (60) days of notification by County by registered mail, return receipt requested, unless otherwise designated by the County's Road Manager. Further, any maintenance, repair, or

construction shall be done in such a manner as to occasion no unreasonable interference with the normal flow and safety to traffic and at the expense of the utility company. When reasonable care has been taken to locate said utility facilities within the right-of-way, the applicant understands that any damages caused by routine maintenance and construction by county forces shall be borne by the applicant Utility.

A general description of the size, type, nature, and extent of the Utility work to be done is as follows: BORE 532' OF FIBER CABLE ALONG INDUSTRIAL BLVD. BORE 907' OF FIBER CABLE ALONG INDUSTRIAL DR N. FIBER CABLE TO BE PLACED IN THE BACK 5' OF ROW. ANY CABLE MARKERS TO BE PLACED SHOULD BE AT REAR OF ROW SO NOT TO INTERFERE WITH COUNTY MAINTENANCE.

The applicant understands and agrees that, except as herein granted, no right, title, claim, or easement to said road right-of-way is granted by the issuance of this permit and if this Utility Facility as listed in the general provisions of the Policy, it will be adjusted to comply with same without cost to the County, unless the variance from the Policy has been approved by the granting of the Permit pursuant to this Application.

The Applicant further understands that the Utility's engineering, plant, or other personnel will be responsible for the staking and construction supervision of the work set out above and as shown on the attached plans.

The applicant further agrees to indemnify and hold county harmless for any and all claims, accidents, damages, liabilities and expenses occasioned wholly, or in part, by any act or omission of applicant, its agents or employees. In case County shall, without fault on its own part, be made a party to any litigation commenced by or against applicant, then applicant shall protect and hold County harmless, and shall pay all costs, expenses and reasonable attorney's fees incurred or paid by County in connection with said litigation.

Madison County agrees to the following stipulations:

- (1) To cooperate with the Utility Company in every way to avoid conflicts in the location, construction, and maintenance of the County Highway and Utility Facility.
- (2) To pursue any and all legal means to see the Policy Standards, except to the extent of any variance shown on the plans filed herewith and approved, are complied with in the facility installation.
- (3) If the County Road Manager or his authorized representative approved the drawing, sketches, and plans submitted by the Applicant, he shall so indicate by signing and dating the Permit Approval at the end of this application, and the Applicant may proceed with the installation; if the drawings, sketches, and plans are not approved, he shall promptly notify the Applicant, and advise it of the reason or reasons. He will also act as the duly appointed representative of the Board of Supervisors and will give his approval to the completed work as being in compliance with the location and standards shown in the Policy and in the Agreement for the installations.

(4) That all joint highway construction and utility adjustment or relocation operations will comply with the requirements of Section S-105.06 and Section S-107-18, Mississippi Standard Specifications for State Aid Road and Bridge Construction, 1989 edition (or current edition).

(5) Should any term of provision of this Applicant Agreement conflict with the law of the State of Mississippi, the Mississippi Constitution, or the United States Constitution, or impair or deny to the Applicant or the County any right protected thereby, it shall be deemed amended to conform to said law or Constitution.

WITNESS the signature of the Applicant this the 10th day of February, 2016.

By: 
(Applicant Signature)

Title: Mgr OPS Plng & Design SE/CA

AGREED TO AND APPROVED BY:

Mr. Trey Baxter
Madison County Board President

Date: _____

ENTERED INTO THE MINUTES OF THE BOARD OF SUPERVISORS OF MADISON COUNTY,

MISSISSIPPI OF THIS _____ DAY OF _____, 20____.

County Engineer



VICINITY MAP

FROM I-55 TAKE THE GLUCKSTADT RD EXIT,
EAST APPROX 1/2 MILE. TURN NORTH ON
INDUSTRIAL BLVD APPROX 1/4 MILE

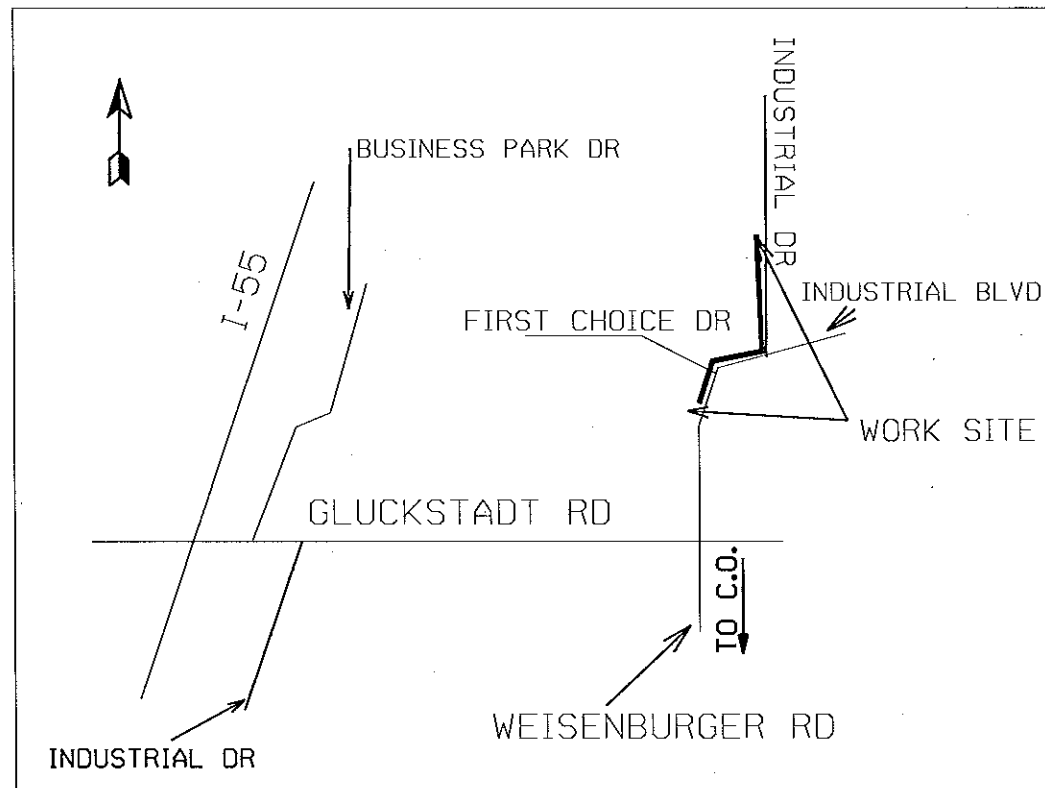

SYMBOL LEGEND		
Proposed	Existing	Description
		AERIAL CABLE
		BURIED CABLE
		BUR JOINT-TRENCH
		BST POLE
		POWER POLE
		ANCHOR & GUY
		PUSH BRACE
		ENCLOSURE
		ENCLOSURE
		MANHOLE
		PIPE/CONDUIT
		CABLE MARKER
		AERIAL SVC WIRE
		BURIED SVC WIRE
		JOINT-TRENCH SVC
	N/A	BORE
	N/A	CUT PAVEMENT
	N/A	SPLICING PIT
	N/A	TRENCH LEN@DEPTH

ATTSE	
PROPOSED TELEPHONE FACILITIES ON RIGHT OF WAY OF MADISON COUNTY	
INDUSTRIAL DR N	
Exchange:	601856
Designer:	Marshall, Brett
Phone:	601-859-3162
Authorization:	67J90549N
Dwg.	1 of 4

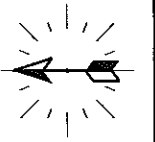

②1 PROPOSED FIBER CABLE

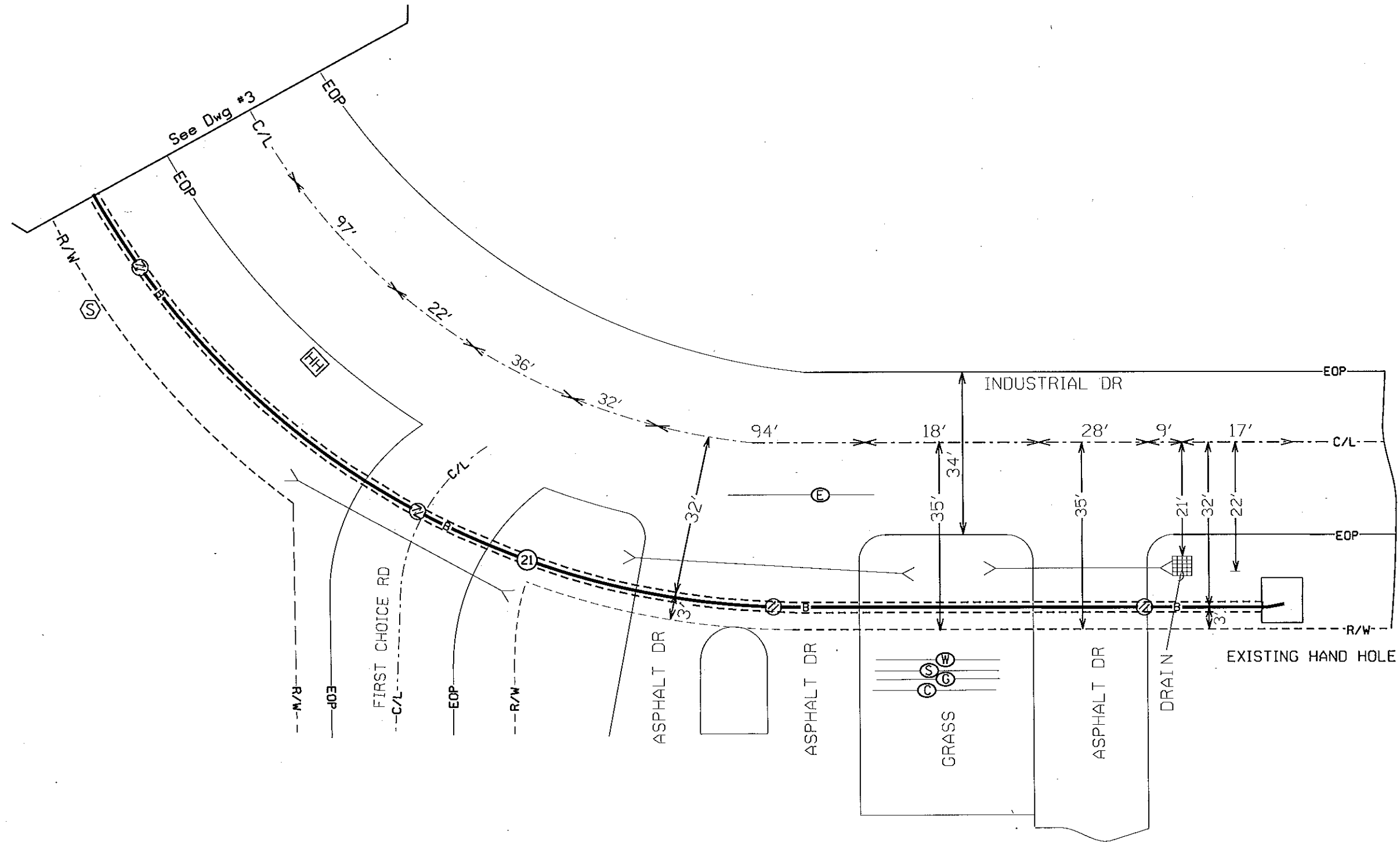

ATTSE	
PROPOSED TELEPHONE FACILITIES ON RIGHT OF WAY OF MADISON COUNTY	
INDUSTRIAL DR N	
Exchange:	601856
Designer:	Marshall, Brett
Phone:	601-859-3162
Authorization:	67J90549N
Dwg.	2 of 4

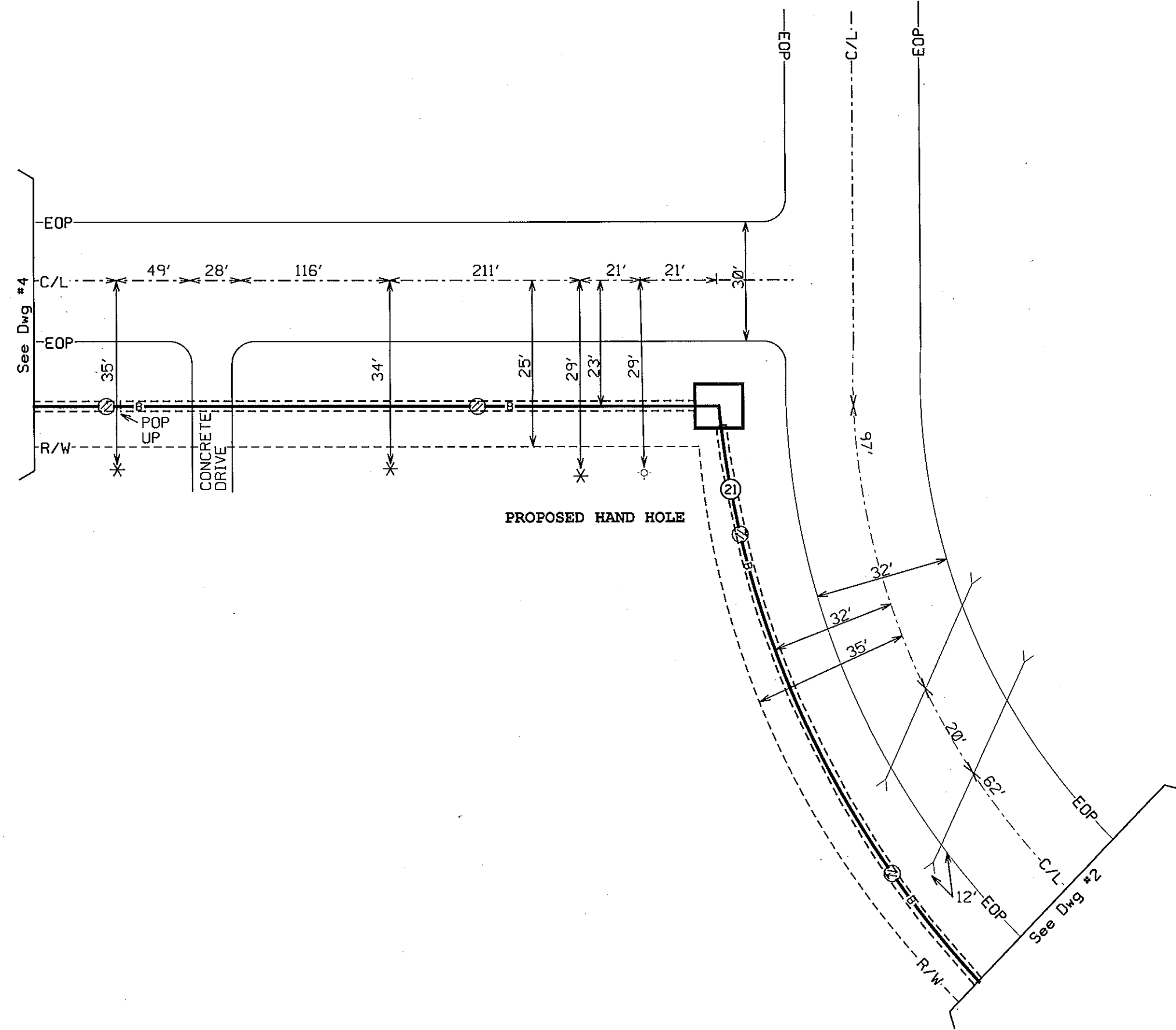
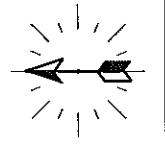

② PROPOSED FIBER CABLE

ATTSE	
PROPOSED TELEPHONE FACILITIES ON RIGHT OF WAY OF MADISON COUNTY	
INDUSTRIAL DR N	
Exchange:	601856
Designer:	Marshall, Brett
Phone:	601-859-3162
Authorization:	67J90549N
Dwg.	3 of 4

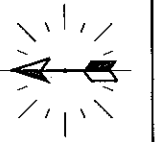

② PROPOSED FIBER CABLE

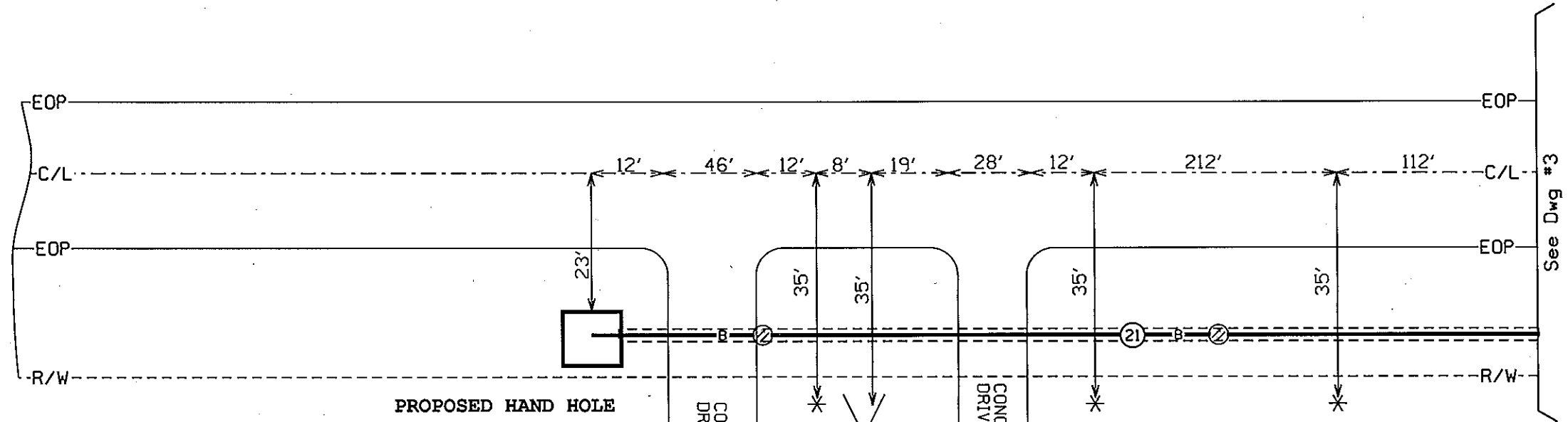

213 INDUSTRIAL DR N

ATTSE	
PROPOSED TELEPHONE FACILITIES ON RIGHT OF WAY OF MADISON COUNTY	
INDUSTRIAL DR N	
Exchange:	601856
Designer:	Marshall, Brett
Phone:	601-859-3162
Authorization:	67J90549N
Dwg.	4 of 4